

Crow Wing County Timber Appraisal Report

Appraised By: Bryan Pike	Sale Type: REGULAR AUCTION SALE	Appraisal Number: TS180133
Appraisal Date: 03/20/2018	Auction Date: 09/28/2018	Permit Number:
		Expiration Date: 09/28/2021
		Page: 1 of 2

Legal Description

RE Code	Sec.	Twp.	Rge	City/Twp	Legal Description
580053100000009	5	136	25	2ND ASSESSMENT	NESW, NWSW, SWSW, SESW, NWSE, SWSE

Block 1 Species	Non-Bid	Bolt %	Volume	Units	Unit Price	Value
Ash		35	500	Cords	\$11.00	\$5,500.00
Basswood		45	95	Cords	\$14.00	\$1,330.00
Oak		24	70	Cords	\$15.00	\$1,050.00
Aspen	X	0	30	Cords	\$30.00	\$900.00
Maple	X	0	20	Cords	\$12.00	\$240.00
Birch	X	25	10	Cords	\$16.00	\$160.00
Subtotal						\$9,180.00
Total						\$9,180.00

Total MBF: 0 Total Cords: 725

Species Scaled: (Sold subject to scale; overruns at bid price) Ash
Species Sold Area Estimate: Aspen, Basswood, Birch, Maple, Oak

Operability: Winter (Frozen Ground) Only **Soil Type:** Lowland Ash, Upland Hardwoods
Topography: Mostly Level **Cutting Acres:** 67.0

Harvest Specifications

Access
Access is thru public land and 2 miles off of Co. Rd. 105

Harvest and Reserves
Harvest: All Aspen and Birch. Merchantable RED Maple. Also; Basswood, RED Oak and Lowland Ash GREATER than 12" DBH. Reserve: All Bur Oak, Sugar Maple and unmerchantable Red Maple. Also; Lowland Ash, Basswood and Red Oak LESS than 12" DBH.

Landings, Access Roads, and Skid Trails
Use only existing access roads. Trails and landings need to be rehabilitated to a satisfactory condition before performance guarantee is returned.

Cutting, Felling, and Skidding
Minimize damage/rubs to reserve species; excessive damage will be charged 2x stumpage. Reduce stump heights to an average of 12". Reserve all non-hazardous snags. Avoid felling timber into areas of regeneration. Do not fell timber into wetlands or across ownership boundaries.

Site, Soil, and Water Protection
Filter strips along wetlands require <5% soil disturbance. If site/soil damage becomes apparent, cease operations and contact sale administrator immediately.

Slash Disposal
Slash may be chipped or must be scattered throughout permit area. Biomass chipping is allowed on this permit...refer to and follow "Site-Level Forest Management Guidelines" for biomass removal.

Tree Size, Marketing, and Special Conditions
Average Tree Sizes: Aspen-14", 6+ sticks; Basswood 16", 6 sticks; Red Oak-15", 5-6 sticks, Ash-15", 5-6 sticks. Biomass volume is estimated to be 215 tons.

Other Remarks
Missing scale tickets will be charged \$50.00 per ticket book. In the case where the County receives a copy of the lockbox ticket stub, but no copy or record of the mill ticket stub, the Permittee will be charged in accordance with MN Statute 90.301.

Crow Wing County Timber Appraisal Report

Appraised By: Bryan Pike	Sale Type: REGULAR AUCTION SALE	Appraisal Number: TS180133
Appraisal Date: 03/20/2018	Auction Date: 09/28/2018	Permit Number:
		Expiration Date: 09/28/2021
		Page: 2 of 2

Site Map:

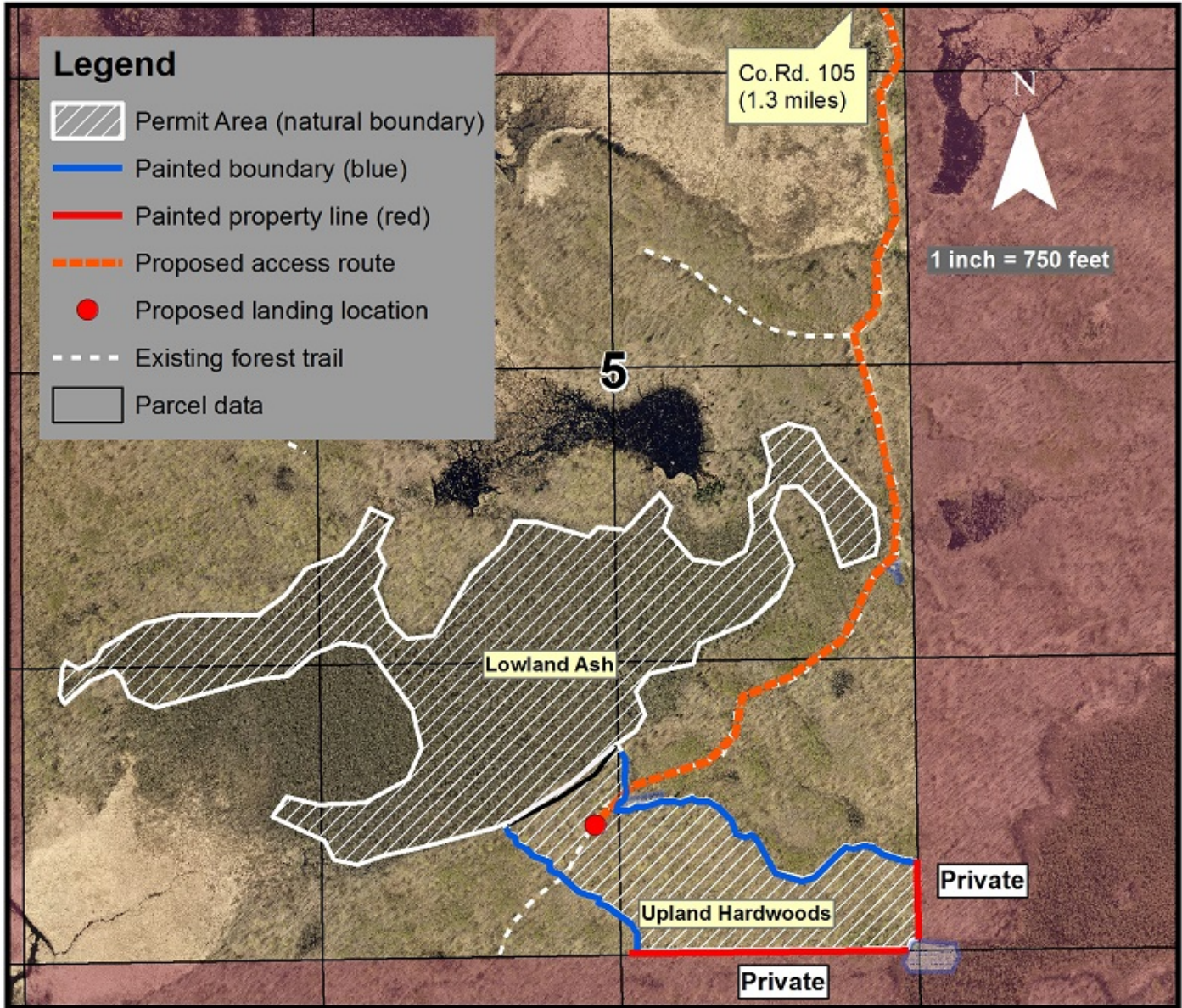

Appraisal examined and approved by _____

Land Commissioner

_____ Date

I hereby agree to abide by the terms and conditions set forth on this appraisal and on timber permit

_____ Contractor

_____ Date