

18

17

Whitefish (18-310 P)

19

20

Bertha (18-355 P)

Clamshell (18-356 P)

30

29

CO RD 16



Total Impervious Coverage for all Lots = 10.5%
 Total Impervious Coverage within 500 ft = 11.4%
 Total Impervious Coverage within 250 ft = 10.7%

THIS DRAWING IS A COMPILATION OF RECORDS AS THEY APPEAR IN THE CROW WING COUNTY OFFICES AFFECTING THE AREA SHOWN AND IS TO BE USED ONLY FOR REFERENCE PURPOSES. THE COUNTY IS NOT RESPONSIBLE FOR ANY INNACCURACIES HERIN CONTAINED.



Lake Bertha

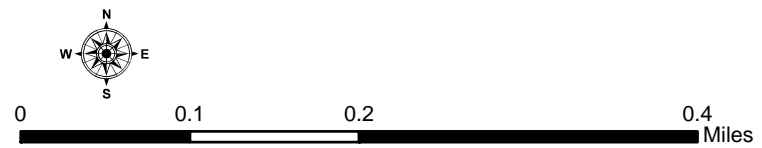

Impervious Surface Coverage by Parcel

 0 - 15 %		Roads
 15 - 20 %		Section Lines
 20 - 25 %		Lakes
 25+ %		



Total Impervious Coverage for all Lots = 10.5%
 Total Impervious Coverage within 500 ft = 11.4%
 Total Impervious Coverage within 250 ft = 10.7%

Lake Bertha

Impervious % within 250 ft of Shoreline

 0 - 15 %	Roads
 15 - 20 %	Section Lines
 20 - 25 %	Lakes
 25+ %	

THIS DRAWING IS A COMPILATION OF RECORDS AS THEY APPEAR IN THE CROW WING COUNTY OFFICES AFFECTING THE AREA SHOWN AND IS TO BE USED ONLY FOR REFERENCE PURPOSES. THE COUNTY IS NOT RESPONSIBLE FOR ANY INNACCURACIES HERIN CONTAINED.

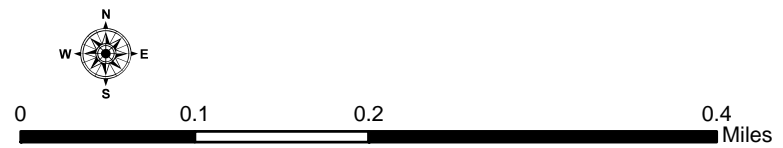

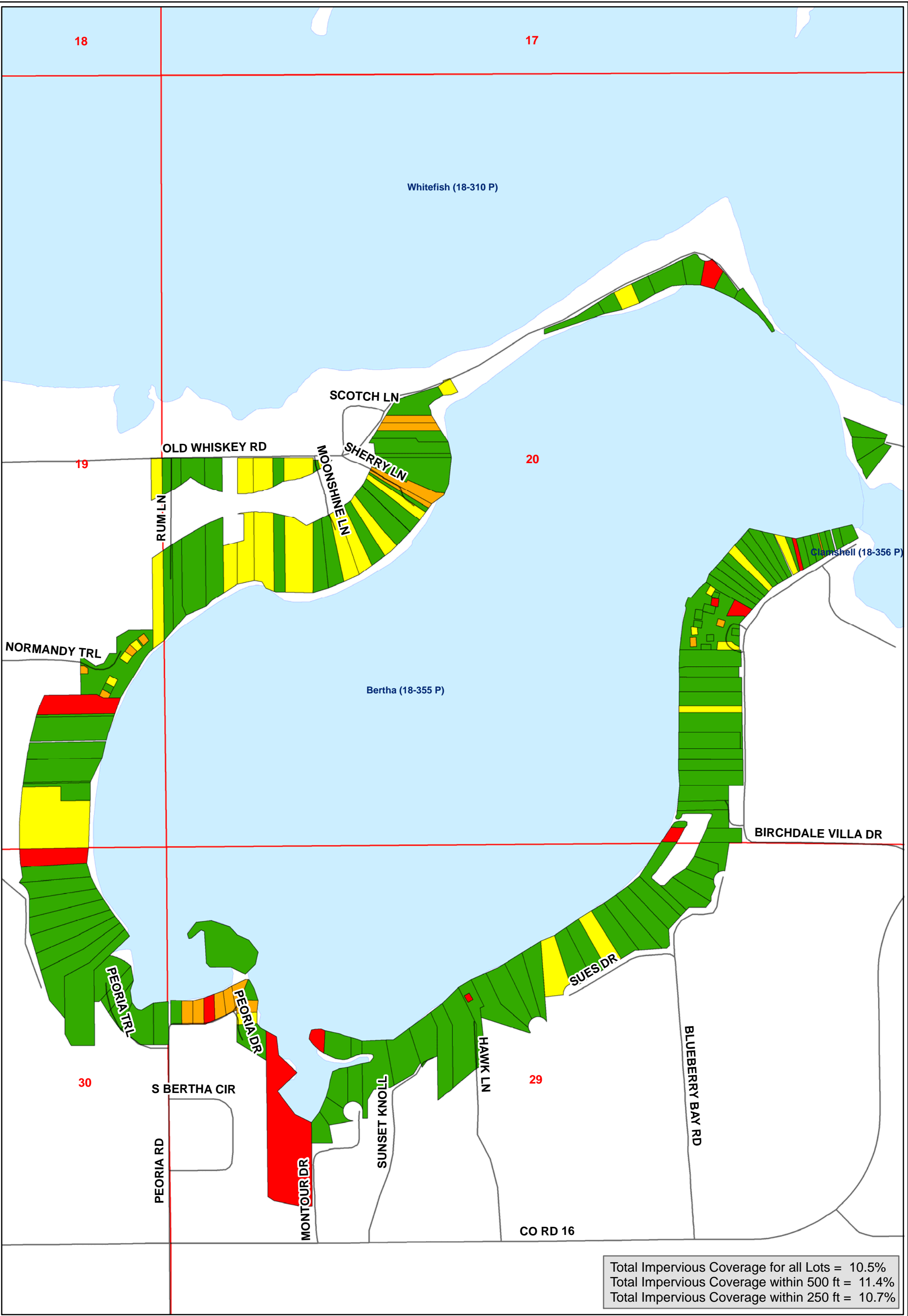

THIS DRAWING IS A COMPILATION OF RECORDS AS THEY APPEAR IN THE CROW WING COUNTY OFFICES AFFECTING THE AREA SHOWN AND IS TO BE USED ONLY FOR REFERENCE PURPOSES. THE COUNTY IS NOT RESPONSIBLE FOR ANY INNACCURACIES HERIN CONTAINED.



Lake Bertha

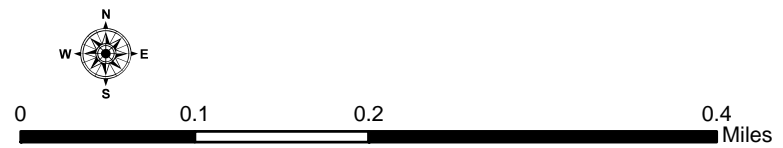

Impervious % within 500 ft of Shoreline

■ 0 - 15 %	— Roads
■ 15 - 20 %	□ Section Lines
■ 20 - 25 %	■ Lakes
■ 25+ %	