

Total Impervious Coverage for all Lots = 2.3%  
 Total Impervious Coverage within 500 ft = 4.0%  
 Total Impervious Coverage within 250 ft = 5.2%

# Platte Lake

## Impervious Surface Coverage by Parcel

- 0 - 15 %
- 15 - 20 %
- 20 - 25 %
- 25+ %
- Roads
- Section Lines
- Lakes

THIS DRAWING IS A COMPILATION OF RECORDS AS THEY APPEAR IN THE CROW WING COUNTY OFFICES AFFECTING THE AREA SHOWN AND IS TO BE USED ONLY FOR REFERENCE PURPOSES. THE COUNTY IS NOT RESPONSIBLE FOR ANY INNACCURACIES HERIN CONTAINED.

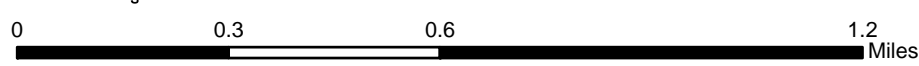

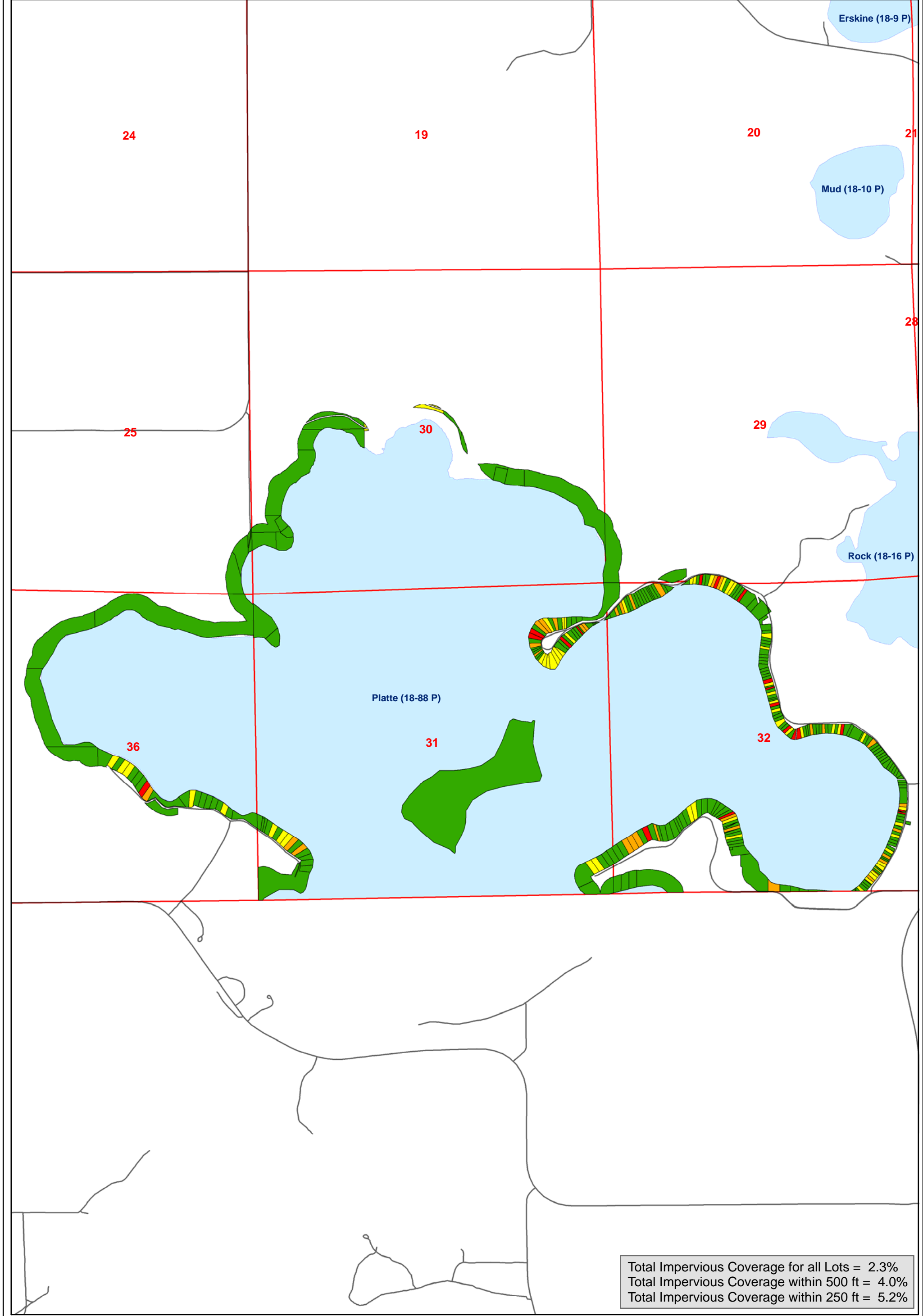

Total Impervious Coverage for all Lots = 2.3%  
 Total Impervious Coverage within 500 ft = 4.0%  
 Total Impervious Coverage within 250 ft = 5.2%

### Platte Lake

#### Impervious % within 250 ft of Shoreline

- 0 - 15 %
- 15 - 20 %
- 20 - 25 %
- 25+ %
- Roads
- Section Lines
- Lakes

THIS DRAWING IS A COMPILATION OF RECORDS AS THEY APPEAR IN THE CROW WING COUNTY OFFICES AFFECTING THE AREA SHOWN AND IS TO BE USED ONLY FOR REFERENCE PURPOSES. THE COUNTY IS NOT RESPONSIBLE FOR ANY INNACCURACIES HERIN CONTAINED.

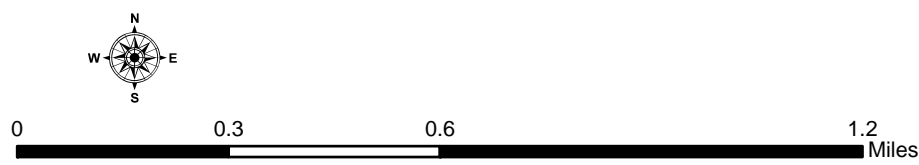

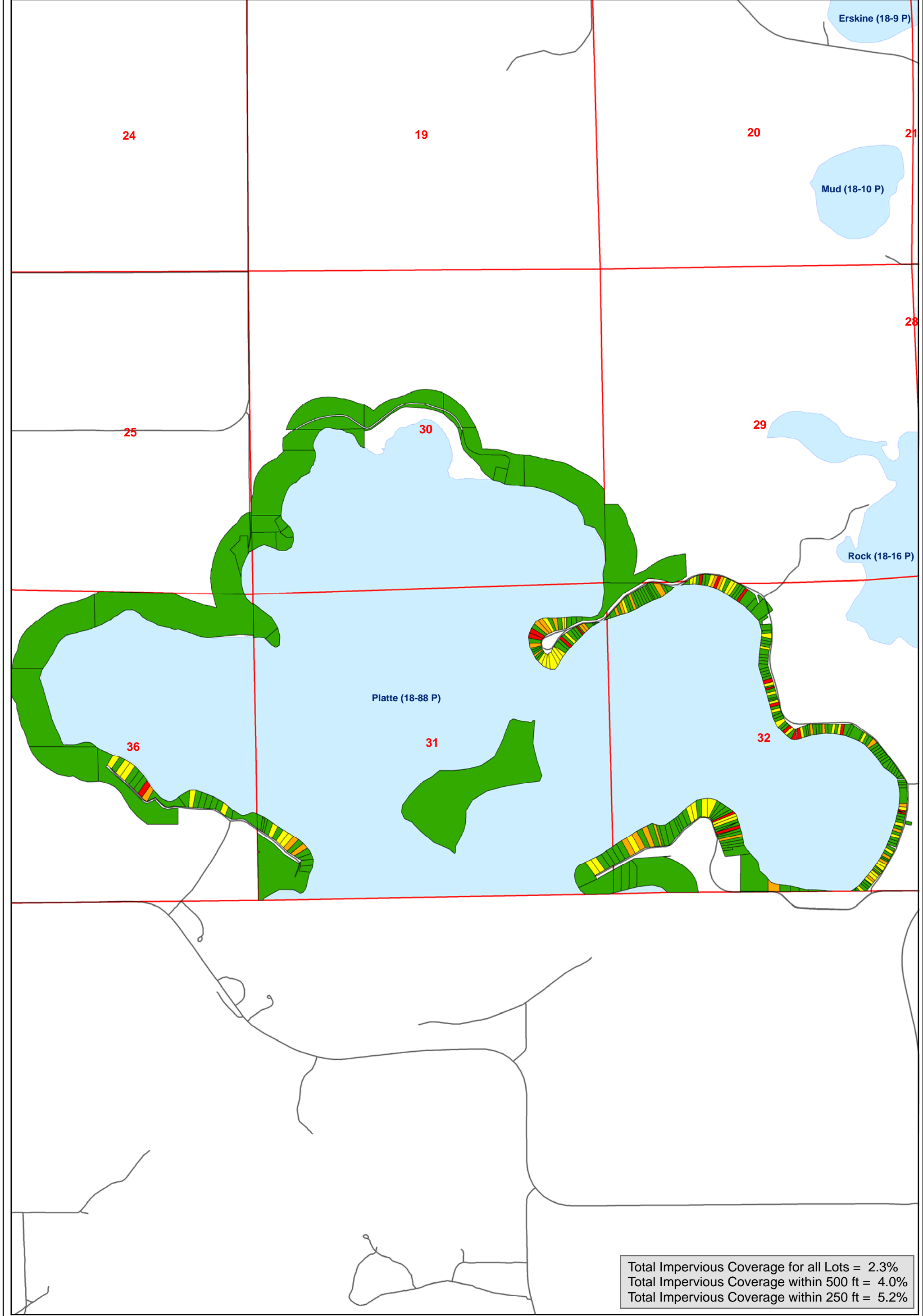

THIS DRAWING IS A COMPILATION OF RECORDS AS THEY APPEAR IN THE CROW WING COUNTY OFFICES AFFECTING THE AREA SHOWN AND IS TO BE USED ONLY FOR REFERENCE PURPOSES. THE COUNTY IS NOT RESPONSIBLE FOR ANY INNACCURACIES HERIN CONTAINED.

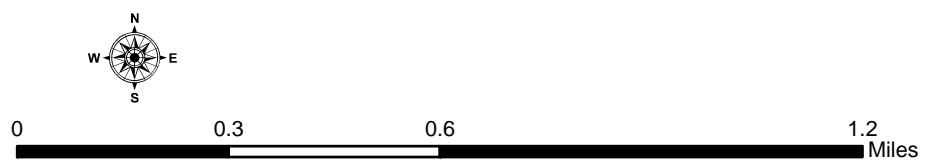

# Platte Lake

Total Impervious Coverage for all Lots = 2.3%  
 Total Impervious Coverage within 500 ft = 4.0%  
 Total Impervious Coverage within 250 ft = 5.2%

**Impervious % within 500 ft of Shoreline**

<span style="display:inline-block; width:15px; height:15px; background-color:green; border:1px solid black;"></span> 0 - 15 %	Roads
<span style="display:inline-block; width:15px; height:15px; background-color:yellow; border:1px solid black;"></span> 15 - 20 %	Section Lines
<span style="display:inline-block; width:15px; height:15px; background-color:orange; border:1px solid black;"></span> 20 - 25 %	Lakes
<span style="display:inline-block; width:15px; height:15px; background-color:red; border:1px solid black;"></span> 25+ %	